

A-Frame Wood Pavilion



Assembly Manual

Wood Traditional Pavilion A-Frame Assembly Manual

Thank you for your purchase of this pavilion.

This manual is designed to simplify the assembly process, however we recommend having an experienced carpenter involved in the project. Please read through the entire manual before starting!

You have purchased a product that consists of heavy, bulky pieces. With your purchase, you assume full responsibility to have the necessary manpower and/or equipment available to unload the items. You also agree that any damage that happens to the equipment, product, or individuals during the unloading process, or during the entire construction process, is your responsibility, and neither the seller, nor the manufacturer, will be held liable for any such damage.

Tools Required for Job



6' & 10'
Step
Ladders



Rubber
Mallet



Hammer



Ratchet with
 $\frac{9}{16}$ " & $\frac{3}{4}$ "
Socket



Hammer
Drill



$\frac{1}{2}$ " Concrete
Drill Bit



Cordless
Drill



25' Tape
Measure



Utility
Knife



Hammer
Tacker



Paint
Brush



(4) 2x4x8' Long
(2) 2x4 Approx 4' Long
for bracing header assemblies

Parts List



3 1/2" Brown
Screws



2 1/2" Brown
Screws



1 1/2" Screws



2 1/4" Screws



3/8 x 3 1/2" Lag
Screws



2" 6 Penny Nails



3/4" Roof Nails



1" Roof Nails



1/2" x 4" Concrete
Lags



1/2" x 4" Bolts



2" & 4" Square
Drive Bits



4", 6", 8" Timber-
lock Screws



Roof Plate



Header Beam



Brace Section



Post

Parts List Continued



1x6 T&G Roof Boards



Common Rafter



Show Rafter



Collar Tie



Ridge Pole



Gable Top Plate



Drip Edge



Roofing Paper



Asphalt Shingles

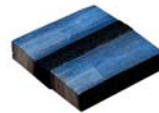

Ridge Caps



Touch up Stain



Country Lane Plaque



Post Skirt



Post Trim



Set your Pavilion Package as close to the building site as possible.



Remove protective shrink wrap. Do not unwrap until you are ready to build. Keep dry and protected until you are ready to assemble the Pavilion.

For Superior Posts Only



Top Piece



Bottom Piece



Slide Top and Bottom Trim Pieces onto Post.

If your Pavilion has Superior Posts install the Trim Pieces onto the Posts before starting on the Pavilion assembly.

Start by finding these Trim Pieces.



Make sure they are aligned properly as shown.

Step # 1

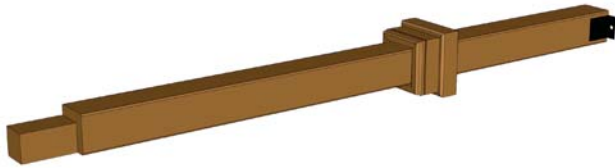

Slide Post Skirt onto Post. Ensure notches on bottom of Post Skirt line up with Bracket. Place (2) Posts with Post Skirts attached, onto cardboard to protect them from getting scratched or damaged.

Step # 3

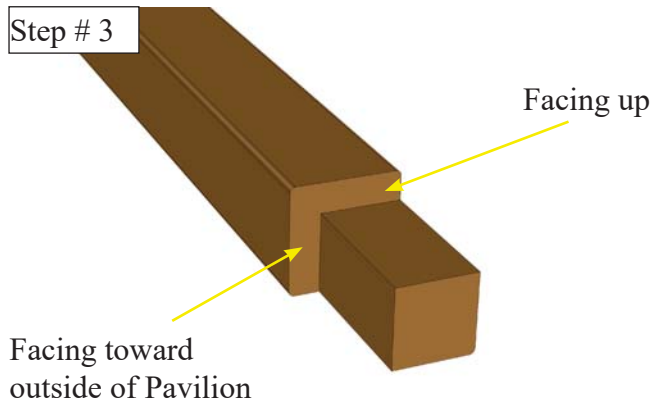

Ensure the Post is placed as shown above.

Step # 5

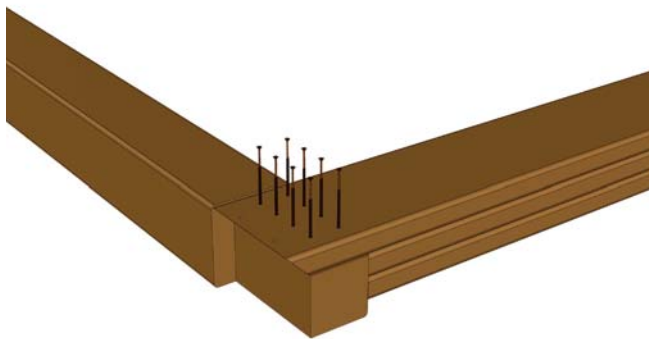

Attach Header to Post using 3 1/2" Brown Screws through pre-drilled holes. Leave the two outside holes empty for now.

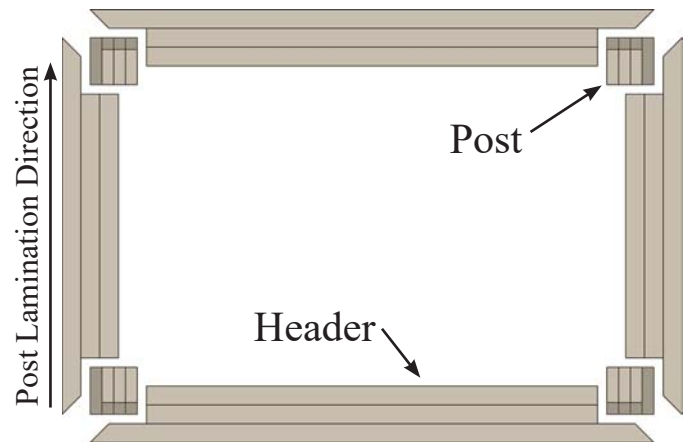

Note the placement of the Posts and Headers above. When placing Posts ensure that the lamination of the Posts run the opposite direction of the long side of the Pavilion as shown above.

Step # 4



Start by placing one of the longer Header Beams on the Posts.

Step # 6



After both sides are properly secured, set Posts & Header Assembly into an upright position. To keep the Header Assembly upright build a temporary A-Frame Brace using your own 8' long 2x4's and fasten with 2 1/2" Screws.

Step # 7



Follow steps 1-6 to build a second assembly.
Set it up directly across from the first one.

Step # 8



Set Left & Right side Headers onto floor at proper locations.

Step # 9



Measure the length of the Header Beam.

Step # 10

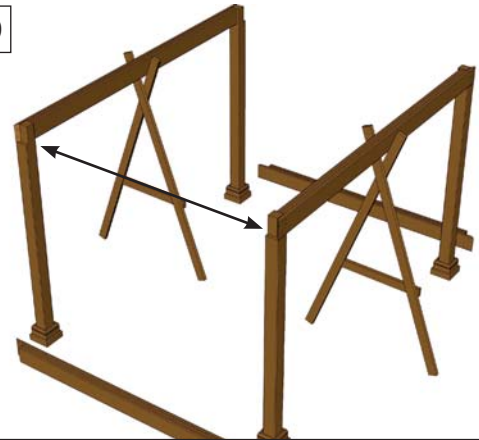

Then measure the distance in between the (2) Post
& Header Assemblies.

Step # 11



Adjust the distance to match the correct spacing
then install the Header Beam.

Step # 12

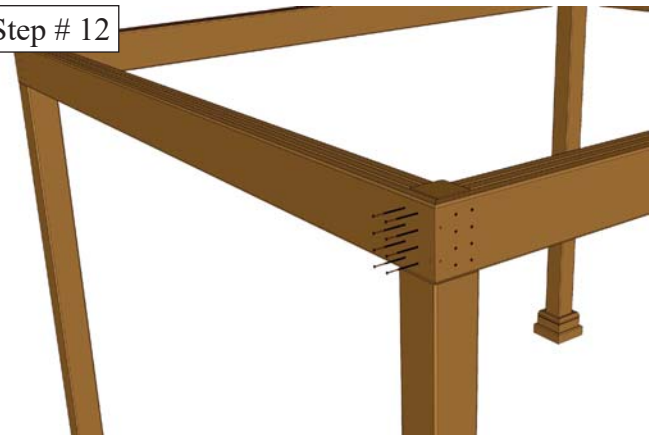

Attach Header to Post using 3 ½" Brown Screws
through all pre-drilled holes.

Step # 13

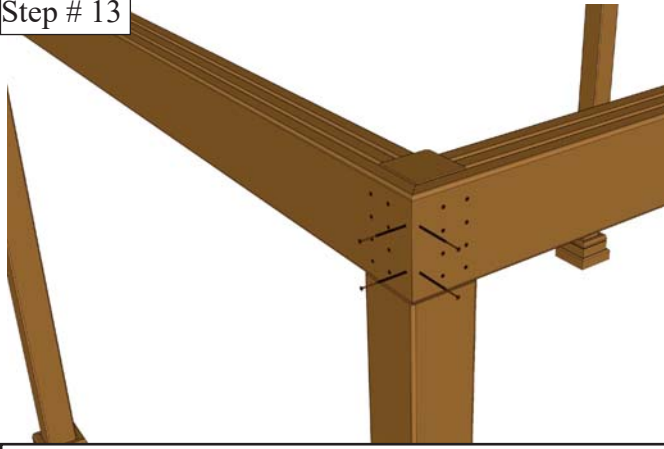

Use 3 ½" Screws to fill in the outside holes.

Step # 14

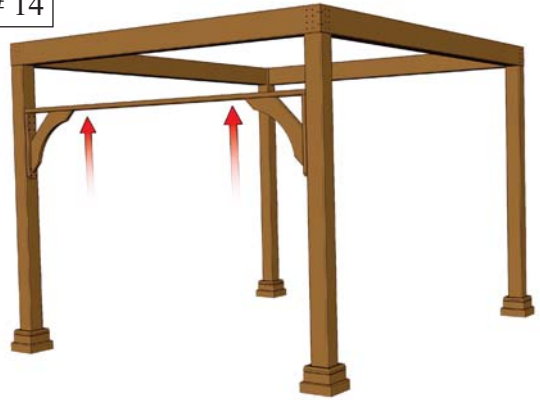

Locate one of the Brace Sections and install it as shown.

Step # 15



Place Brace Section between Posts and tight up against Header. Nudge into place using a Rubber Mallet if necessary. Brace section should be centered on Header above and will not be centered on Post.

Step # 16

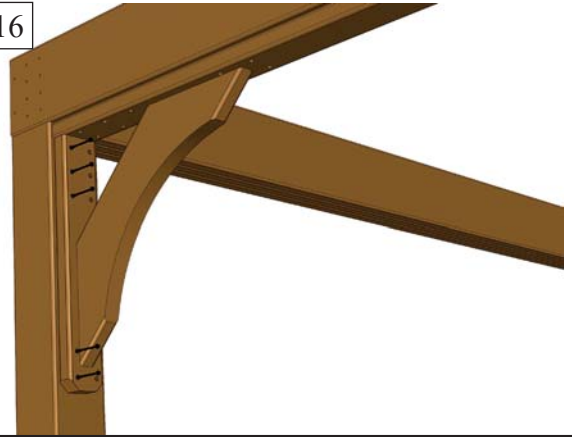

Fasten Brace to Post using 4" Timberlocks Screws. Fill all pre-drilled holes.

Step # 17



Use 4" Timberlock Screws to fasten the Brace to the Header.

Step # 18



Brace Assembly Complete

Step # 19



Measure diagonally from corner to corner to ensure the Post and Header assembly is square. Adjust Post placement if necessary.

Step # 20

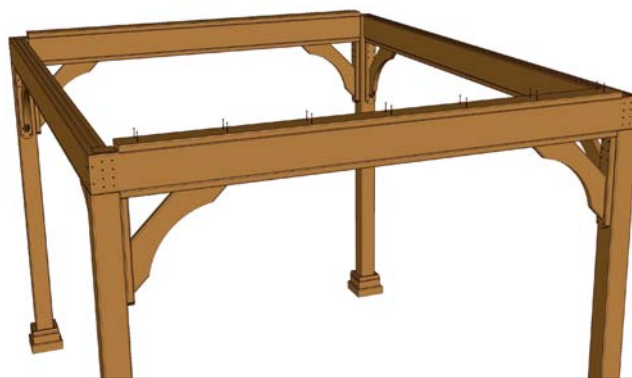

Install the Gable Plate and fasten it to the Header using 3 1/2" Brown Screws. Make sure it is centered end to end.

Step # 21



Install the Roof Plates. Keep them pushed in against the Gable Plates and centered end to end.

Step # 22



Fasten the Roof Plate to the Header using a 3/8" Lag and Washer in each hole.

Step # 23



Install the Vertical Web Pieces on the marked locations.

Step # 24

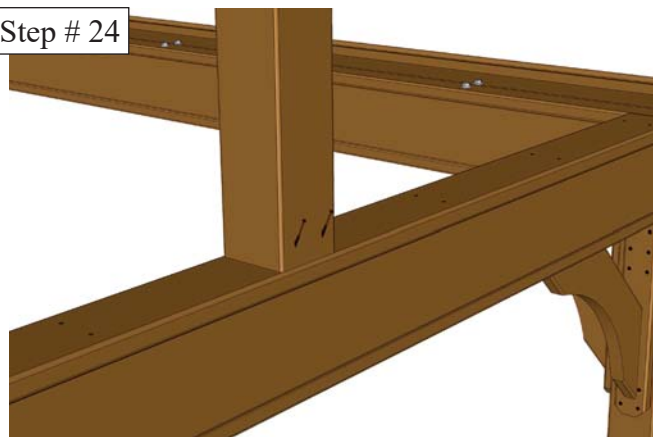

Fasten them to the Gable Plate using 3 1/2" Brown Screws.

Step # 25



Install the Ridgepole. Keep it centered end to end.

Step # 26

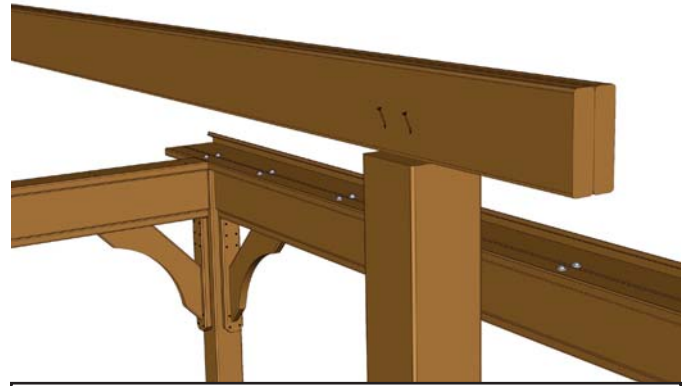

Fasten it to the Web Piece using 3 ½" Brown Screws.

Step # 27



Install the Rafters using the marked locations on the Roof Plate.

Step # 28

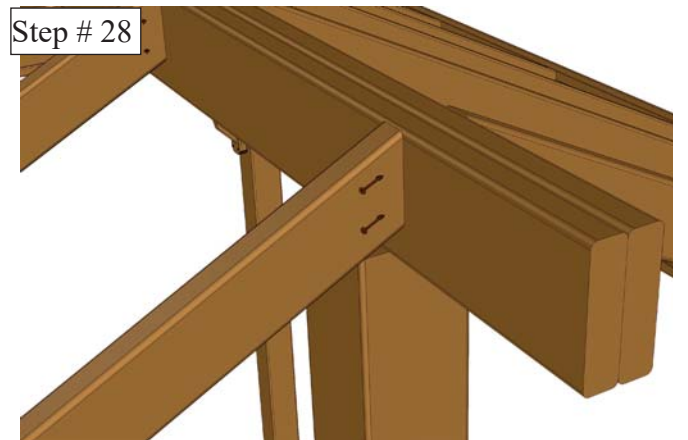

Toe in 3 ½" Brown Screws at the top to fasten the Rafters to the Ridgepole.

Step # 29

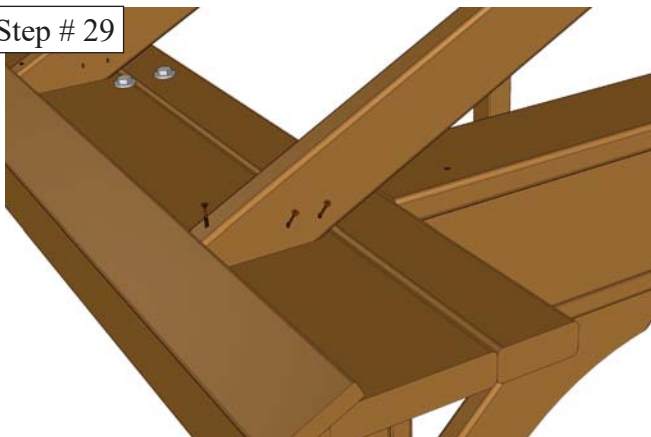

Fasten the Rafters to the Roof Plates using 3 ½" Brown Screws in from the sides and a 2 ½" Screw on the end.

Step # 30

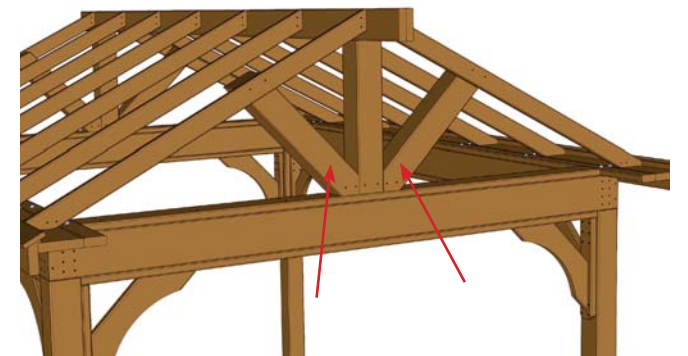

Install the Side Web Pieces.

Step # 31

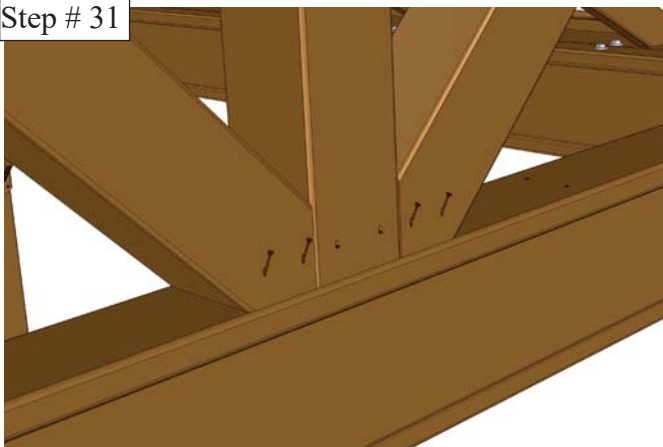

Fasten them to the Gable Plate using 3 ½" Brown Screws.

Step # 32

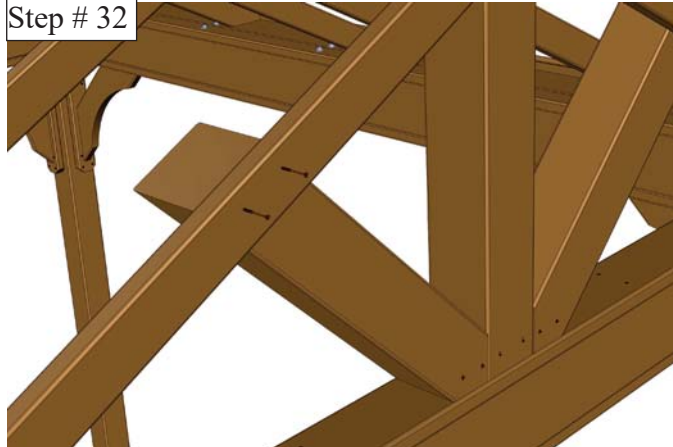

Fasten the Rafters to the Web Piece using 3 ½" Brown Screws.

Step # 33

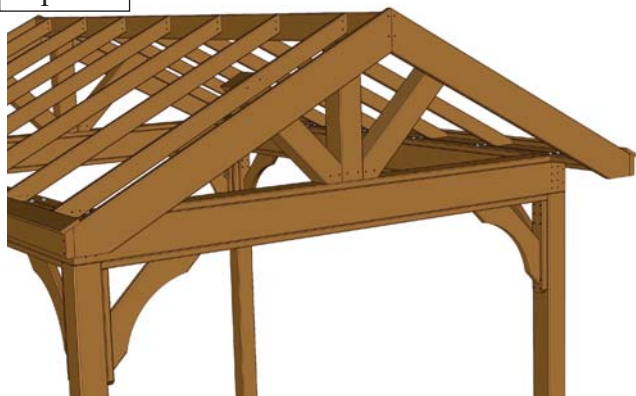

Install the Show Rafters.

If your Pavilion has an Electrical Package follow the steps on page 21 before continuing.

Step # 34

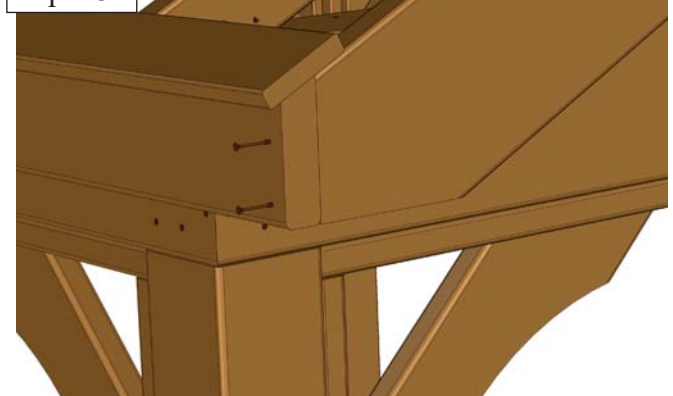

Fasten the Faceboard to the Show Rafter using 3 ½" Brown Screws.

Step # 35



Fasten the Show Rafters to the Ridgepole using 3 ½" Screws.

Step # 36



Install the T&G Roof Boards.

Step # 37

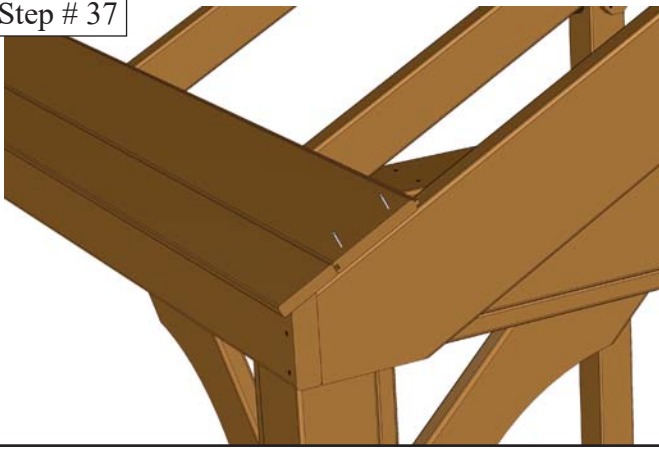

Fasten the T&G Roof Boards with 2" Nails.
Use (2) Nails per Rafter.

Step # 38



Roof Boards installation finished.

Step # 39



Install the Tar Paper.

Step # 40



Install the Drip Edge.

Step # 41

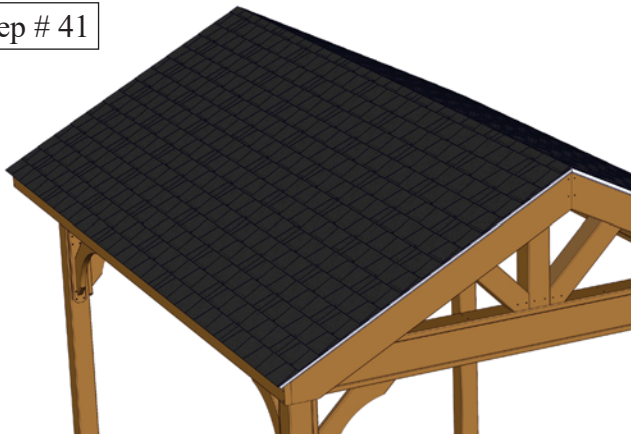

Install the Shingles.

Step # 42



Finish the roof with the Cappers.

Step # 43

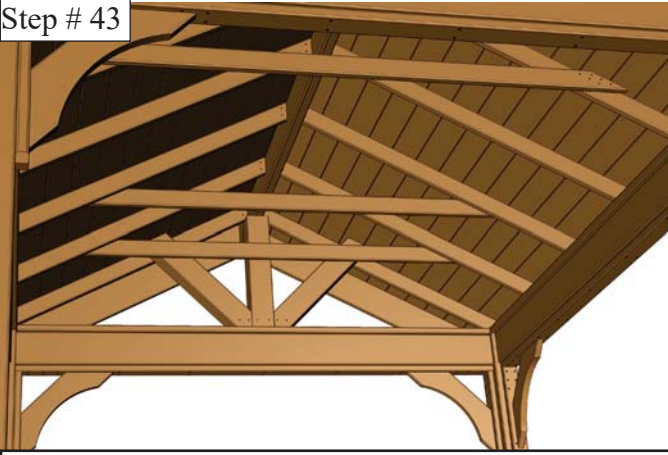

Install the 2x4 Collar Ties.
Keep them centered and up against the Roof Boards.

Step # 44

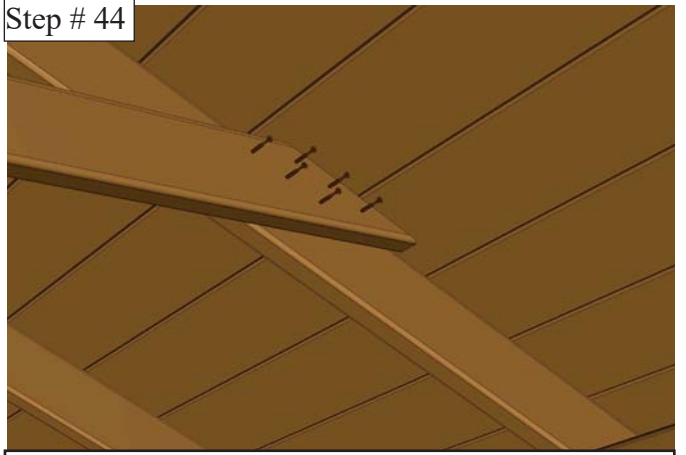

Fasten the Collar Ties to the Rafters using 2 ½" Screws in the pre-drilled holes.

Step # 45



Install the Corner Covers.
Keep them up against the Roof Plate and fasten them using 2 ½" Screws.

Step # 46



Completed Pavilion.

For 6 post layouts start on the next page.

Step # 1



Slide the Post Skirts onto the Posts from the top down.
Make sure the notches on the Post Skirt are lined up with the Brackets on the Post.

Step # 2

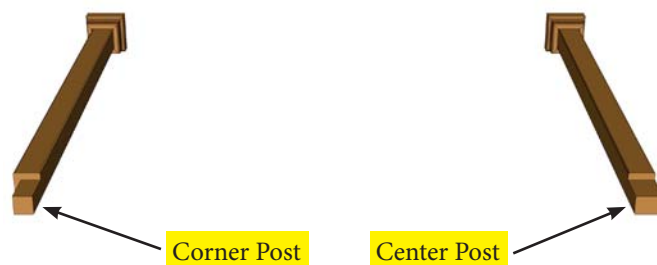

Find a Center Post and a Corner Post and lay them out as shown.

Step # 3

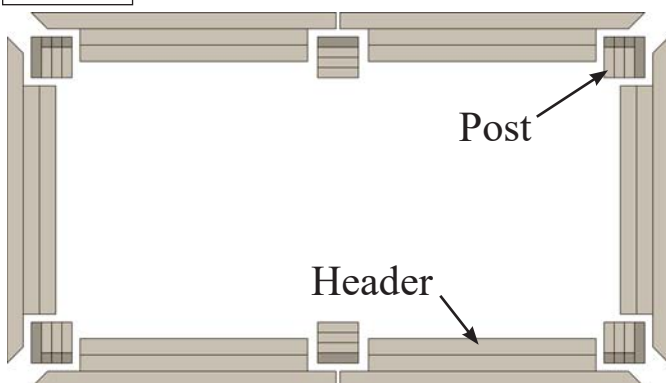

Make sure the Post and Headers are assembled as shown in the illustration.

Step # 4



Place one of the Headers onto the Posts.

Step # 5

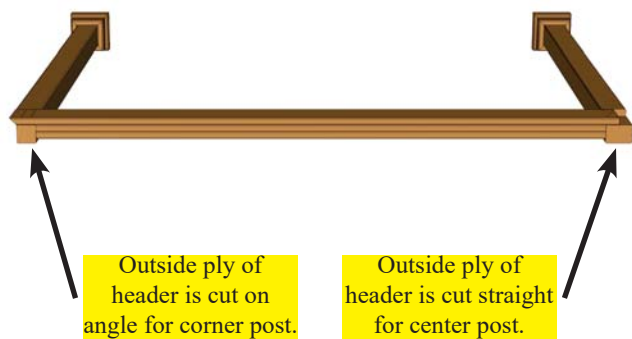

Make sure the Header is aligned properly as shown.

Step # 6

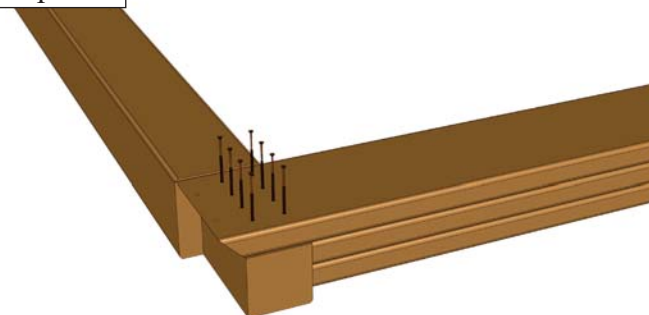

Attach Header to Post using 3 1/2" Brown Screws through pre-drilled holes.
Leave the two outside holes empty for now.

Step # 7



After both sides are properly secured, set Posts & Header Assembly into an upright position. To keep the Header Assembly upright build a temporary A-Frame Brace using your own 8' 2x4's.

Step # 8



Follow steps 1-6 to build a second assembly. Set it up directly across from the first one.

Step # 9

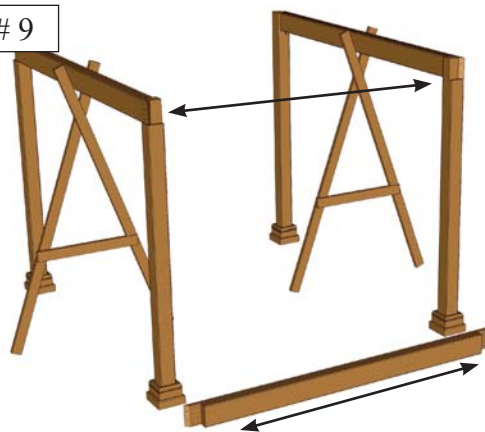

Place one of the End Headers in position then measure the length of the Header Beam. Then measure the distance between the two Post and Header Assemblies. Adjust the distance to match the correct spacing if necessary.

Step # 10

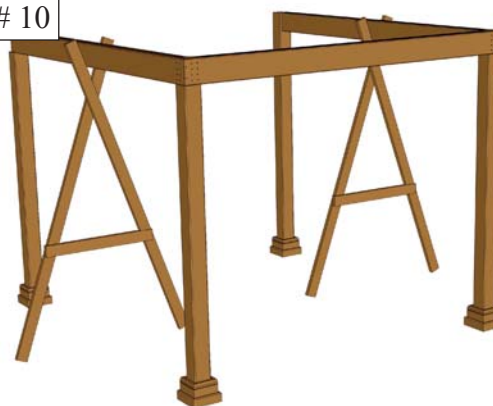

Attach Header to Posts using 3 1/2" Brown Screws through all pre-drilled holes.

Step # 11

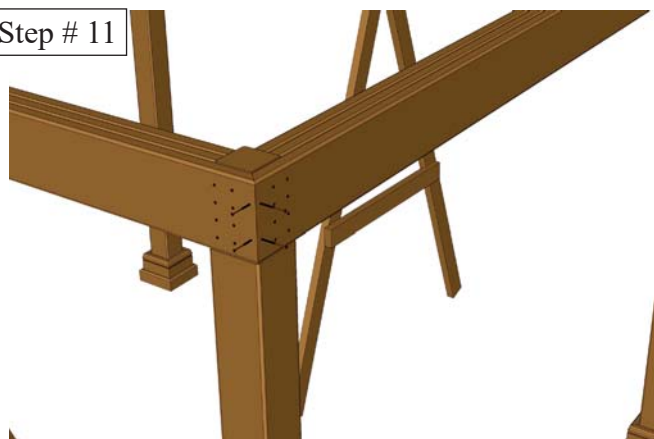

Make sure the outside holes get filled in.

Step # 12



Set up another Post and Header assembly using the previous steps.

Step # 13



Add the rest of the Headers to finish the frame.

Step # 14

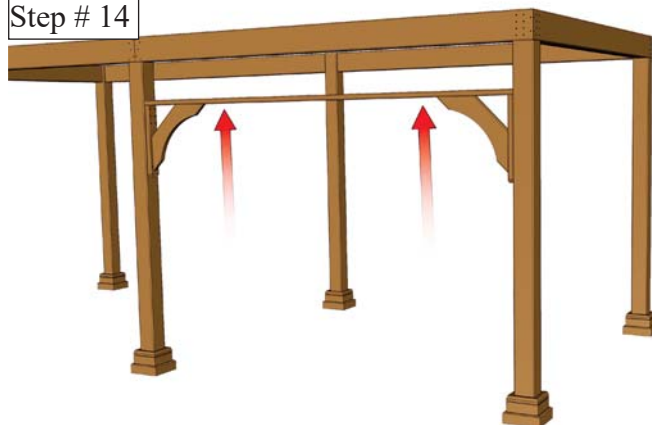

Locate one of the Brace Sections and install it as shown.

Step # 15

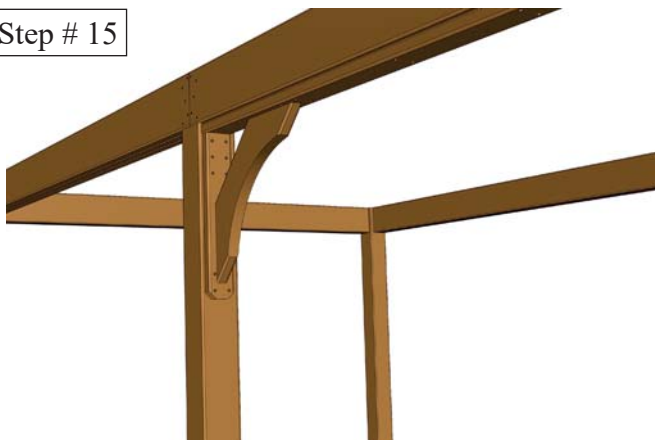

Place Brace Section between Posts and tight up against Header. Nudge into place using a Rubber Mallet if necessary. Brace section should be centered on Header above and will not be centered on Post.

Step # 16

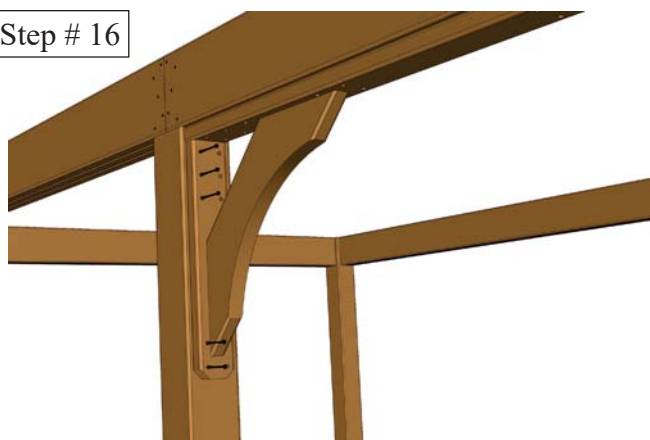

Fasten Brace to Post using 4" Timberlocks Screws. Fill all pre-drilled holes.

Step # 17

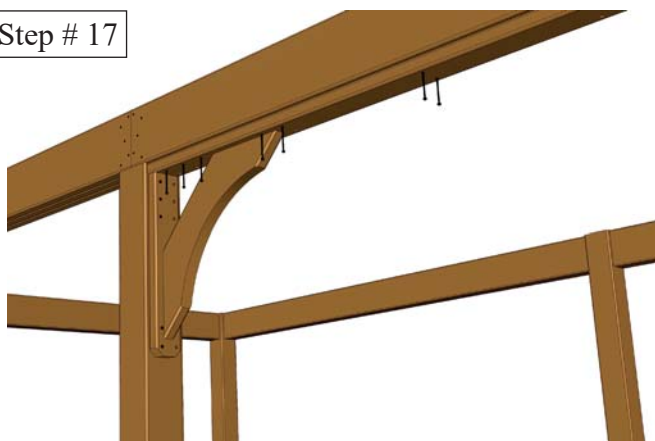

Use 4" Timberlock Screws to fasten the Brace to the Header.

Step # 18



Finish installing the rest of the Headers.

Step # 19

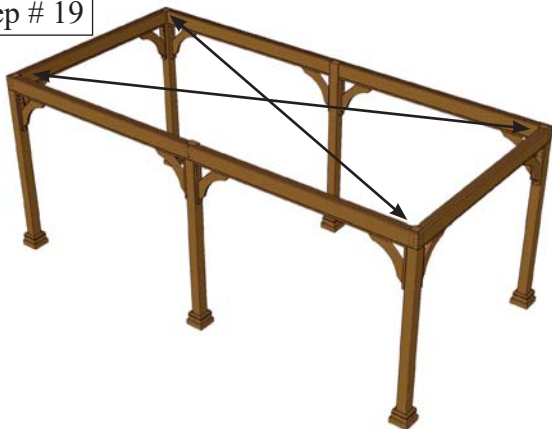

Measure the Pavilion corner to corner and make sure it is squared.

Step # 20

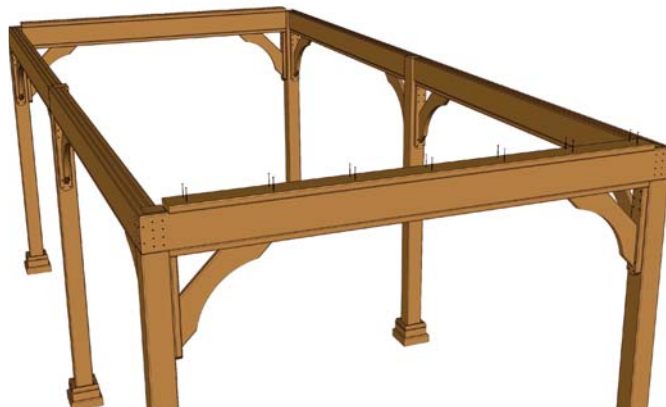

Install the Gable Plate and fasten it to the Header using 3 1/2" Brown Screws. Make sure it is centered end to end.

Step # 21



Locate and install the Roof Plates. Keep them in against the Gable Plates and center them end to end.

Step # 22

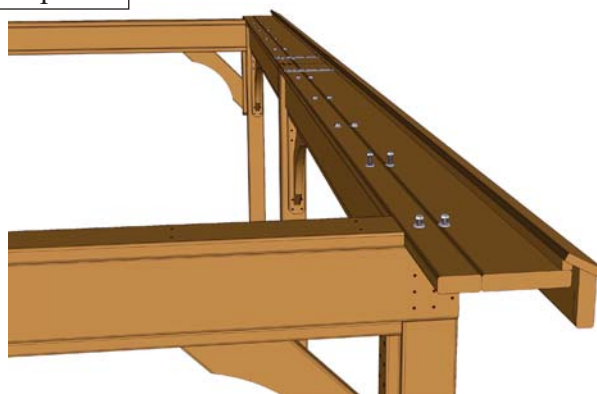

Fasten the Roof Plate to the Header using a 3/8" Lag and Washer in each hole.

Step # 23



Install the Vertical Web Pieces on the marked locations.

Step # 24

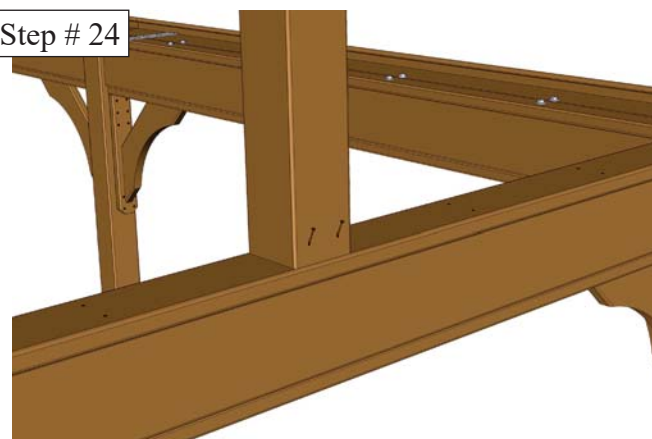

Fasten them to the Gable Plate using 3 1/2" Brown Screws.

Step # 25



Install one side of the Ridge Pole.
Note: Use 2 of the 2x4's from the X-braces to make a temporary support for the Ridge Pole after it is leveled.

Step # 26



Fasten it to the Web Piece using 3 ½" Brown Screws.

Step # 27



Install the Rafters using the marked locations on the Roof Plate.

Step # 28

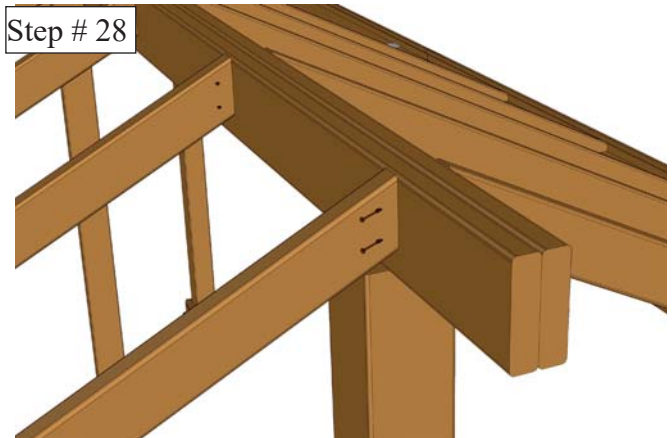

Toe in 3 ½" Brown Screws at the top to fasten the Rafters to the Ridgepole.

Step # 29

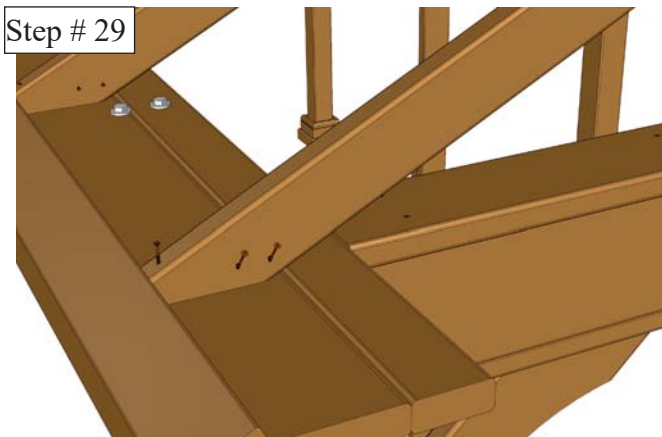

Fasten the Rafters to the Roof Plates using 3 ½" Brown Screws in from the sides and a 2 ½" Screw on the end.

Step # 30



Install the Side Web Pieces.

Step # 31

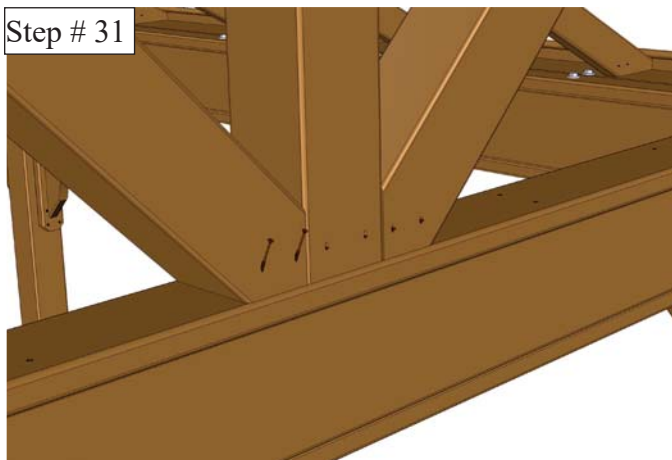

Fasten them to the Gable Plate using 3 1/2" Brown Screws.

Step # 32

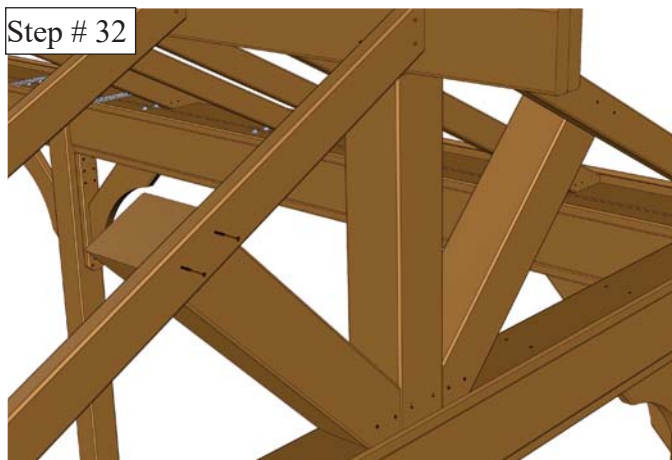

Fasten the Rafters to the Web Piece using 3 1/2" Brown Screws.

Step # 33



Repeat steps 25-32 to finish the other side of the roof.

Step # 34



Use (2) 2 1/2" Brown Screws approximately every 16" to fasten the two Ridge Pole sections together.

Step # 35

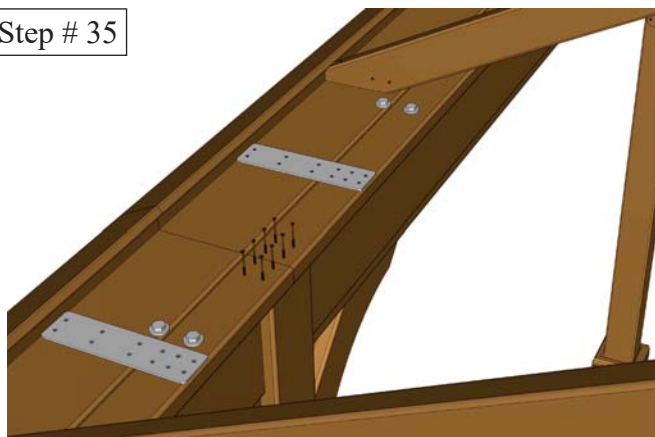

Fasten the Roof Plate to the Post below using (8) 3 1/2" Screws in the predrilled holes.

Step # 36

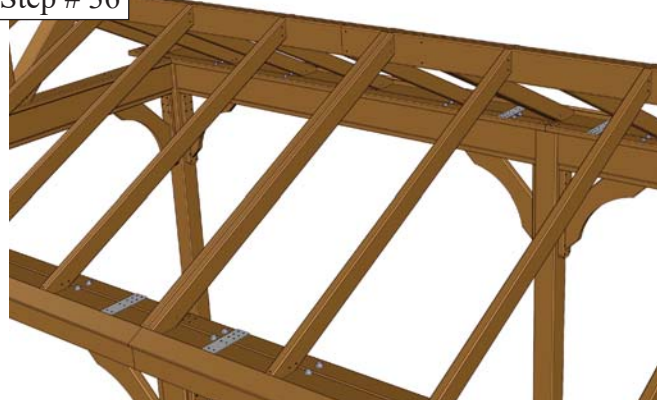

Install the Center Double Rafters. Fasten them using the same method as the rest of the Rafters.

Step # 37

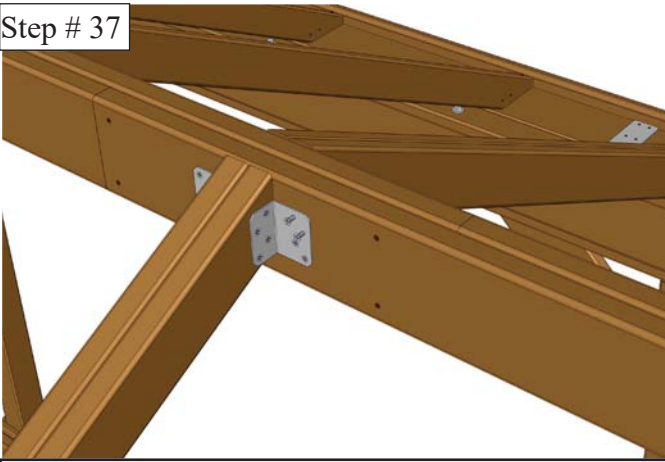

Install the Simpson Rafter Brackets using 1 ½" Screws.

Step # 38

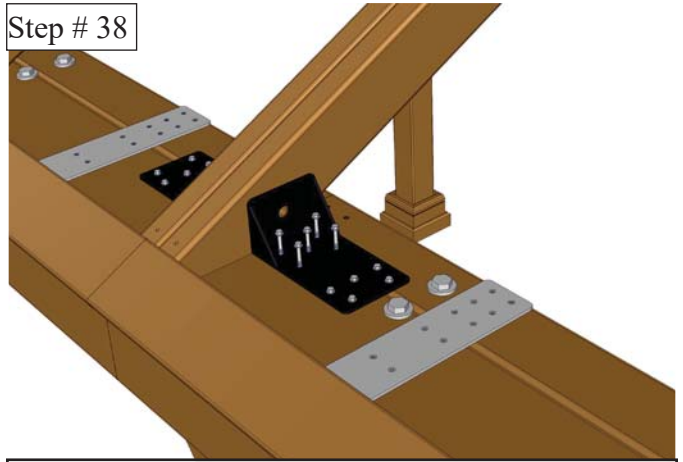

Install the Rafter Angle Brackets on the Roof Plate using 1 ½" SDS Screws.

Step # 39

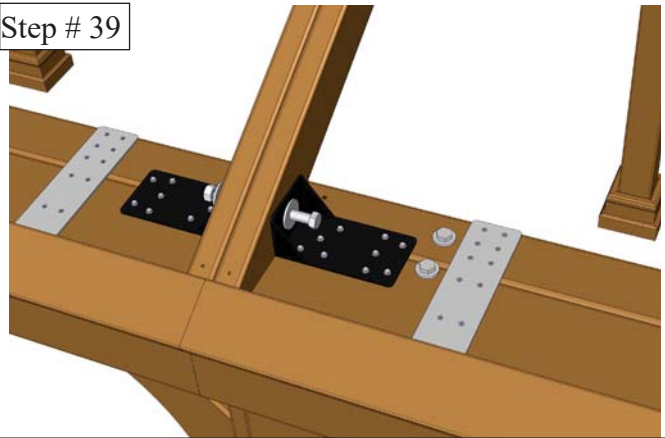

Insert a 4 ½" Bolt with a Washer on both ends and tighten it.

Step # 40



Locate the Knee Brace.

Step # 41

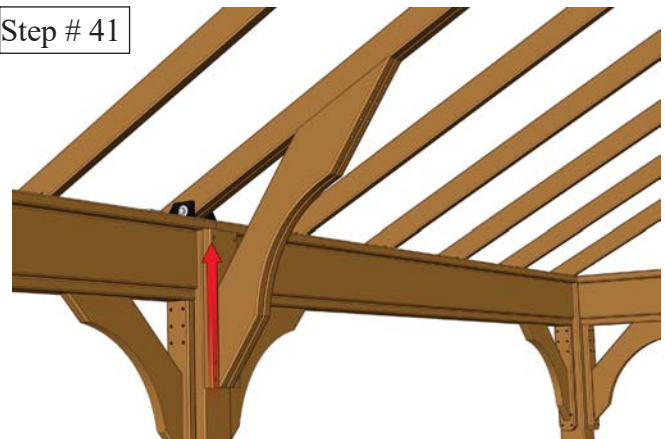

Place the Brace in position, make sure it is centered and up against the Roof Plate.

Step # 42

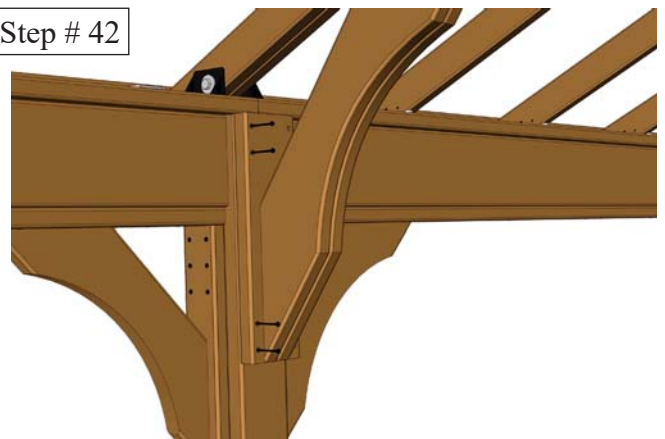

Fasten the Brace to the Post using (8) 4" Timber Locks.

Step # 43

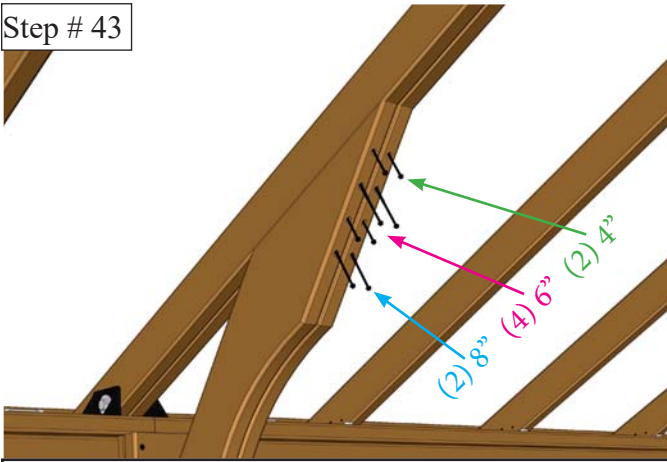

Fasten the top to the Center Rafter using (2) 8", (4) 6", and (2) 4" Timberlocks.

Step # 44



Install the Show Rafters.

The rest of the steps are the same as the 4 post. Follow steps 34-46 in the 4 post section to finish.



Electrical Section

Step # 1

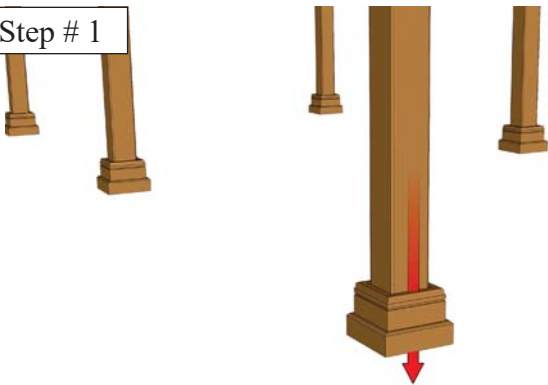

Using a $\frac{1}{2}$ bit drill a hole down through the post skirt.
Keep it centered on the Post.

Step # 2

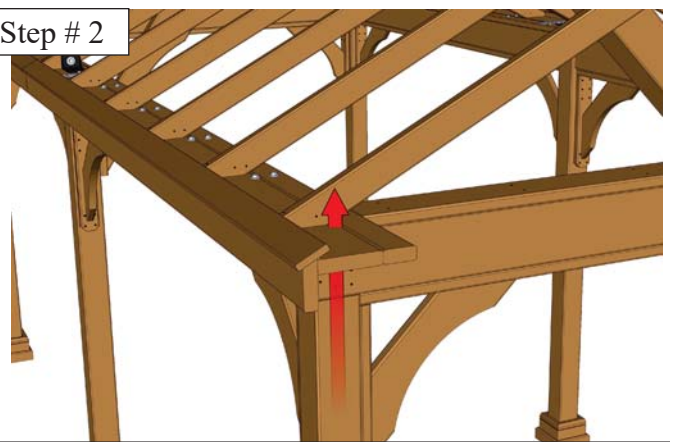

Drill a hole up through the Roof Plate.
Keep it centered on the Post and in against the Header.

Step # 3



Run the wire up through the Post Skirt and out the Roof Plate.

Step # 4



Run the Wire along the Roof Plate in against the Rafters.
Fasten it using Wire Staples.

Step # 5

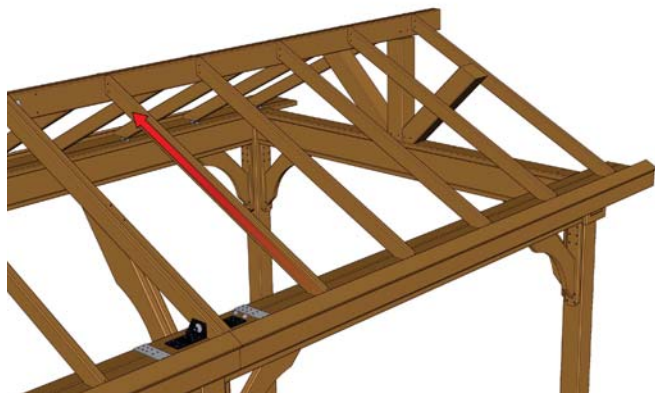

Run the Wire up the Rafter of your choice.

Step # 6

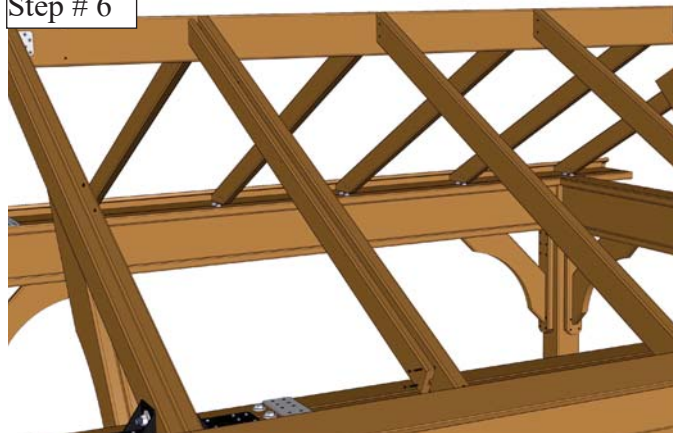

Attach the wire to the Rafter using the included Wire Cover.
Trim the Wire Cover to fit the Rafter and fasten it using 2" Screws.

Step # 7

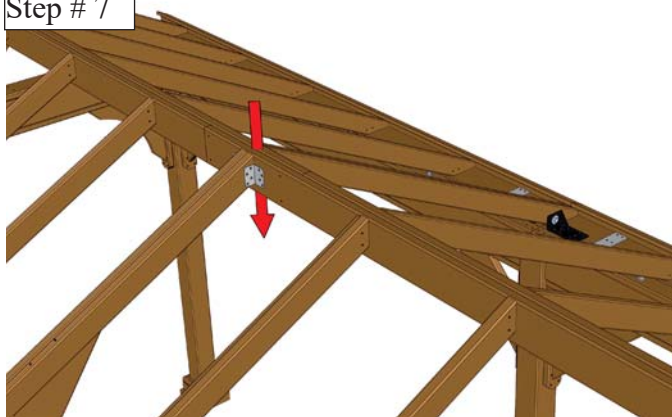

Drill a $\frac{1}{2}$ " hole in the Ridge Pole at your desired location and run the wire down through.

Step # 8

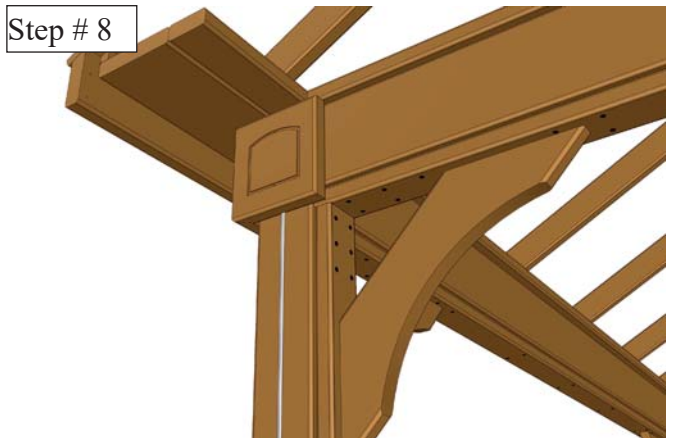

Install the Post Trim to cover the Wire.

Step # 9



Notch the back side of the Post Trim before installing to fit the Wire.

Step # 10

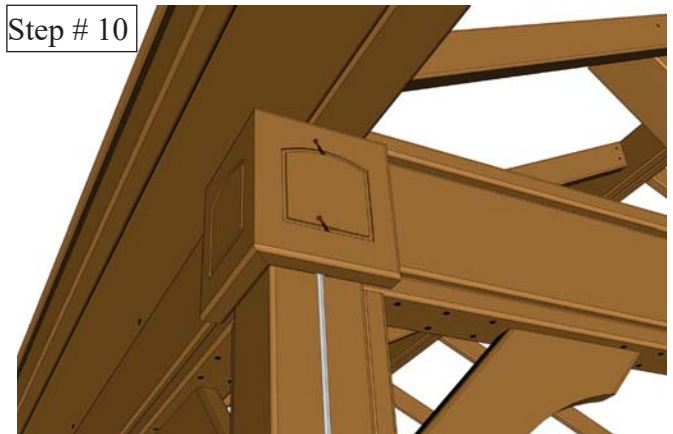

Fasten the Post Trim to the Header using 2 $\frac{1}{2}$ " screws.
Angle the screws to avoid hitting the Wire underneath.

Step # 11



Cut the Wire Strip to fit between the Post Skirt and Post Trim.
Then mark the location of the Switch and Receptacle Box and drill 2 holes 5" apart.

Step # 12



Put the Wire Strip in place then pull some excess Wire up from the bottom.
Cut the Wire then run both ends out through the holes in the Strip.

Step # 13

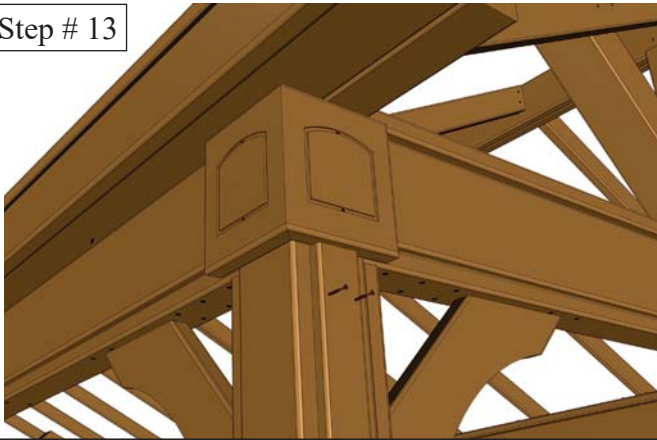

Fasten the Wire Strip to the Post using 2 1/2" screws in all the pre-drilled holes.

Step # 14

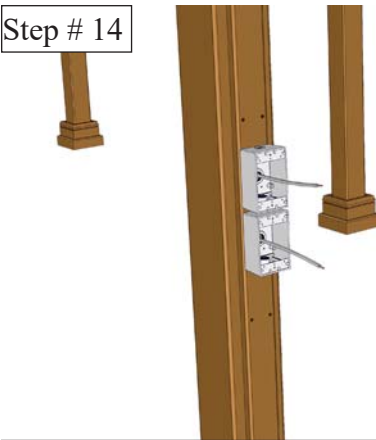

Finish the Post by installing the Switch and Receptacle Box.
Fasten them to the Post using 2 1/2" Screws.

Optional Superior Posts

Step # 1



Locate the Superior Post Panels.

Step # 2



Start placing the Panels into the Bottom Trim piece.
Make sure they are aligned properly.

Step # 3

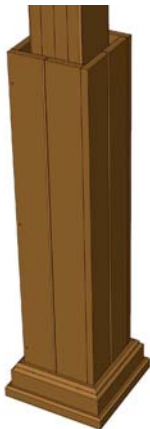

When installed properly they should line up as shown.

Step # 4

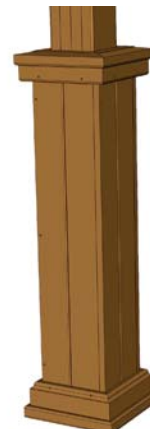

Slide the Top Trim piece down to hold them in place.
Make sure it is seated down against.

Step # 5



Fasten the Panels together using (3) 1 ½" Screws per Panel.

Step # 6

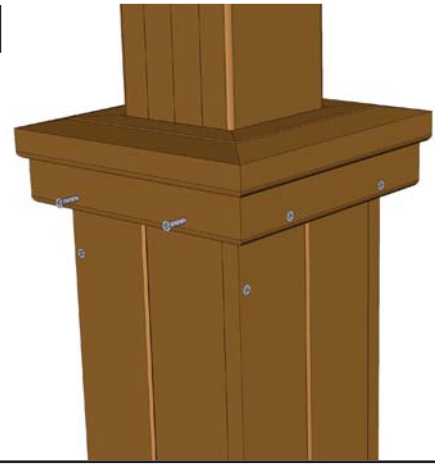

Fasten the Top Trim to the Panels using (2) Screws per side.

Step # 7

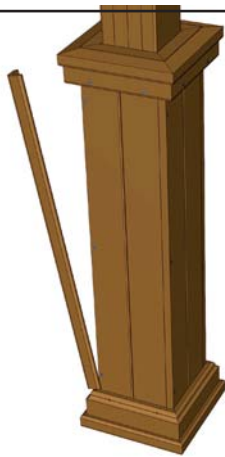

Install the Corner Trim.

Step # 8



Fasten the Corner Trim using (3) Screws per piece.

Step # 9



Attach the Bottom Trim to the Panels using (2) Screws per side.

Step # 10



Completed Post.



When attaching your Pavilion to your Patio, Ensure you attach it to a solid structure. (I.e. Concrete Base, Concrete Pad, Deck etc. Do not attach to Pavers alone. Pavers will not hold your Pavilion down in high winds)



First lift Post Base Trim up and away from Brackets. Using a Hammer Drill a ½" Drill Bit (Not Included). Drill into the Footings below.



Insert and tighten ½" Lag Bolt. After tightening Bolt lower Post Base Trim into place.



Slide the Post Skirt down firmly into place.

Note:

Attach directly to Concrete Footer or Concrete Pad. Do not attach through Pavers. Photos used in this Assembly Manual are for instructional purposes only!

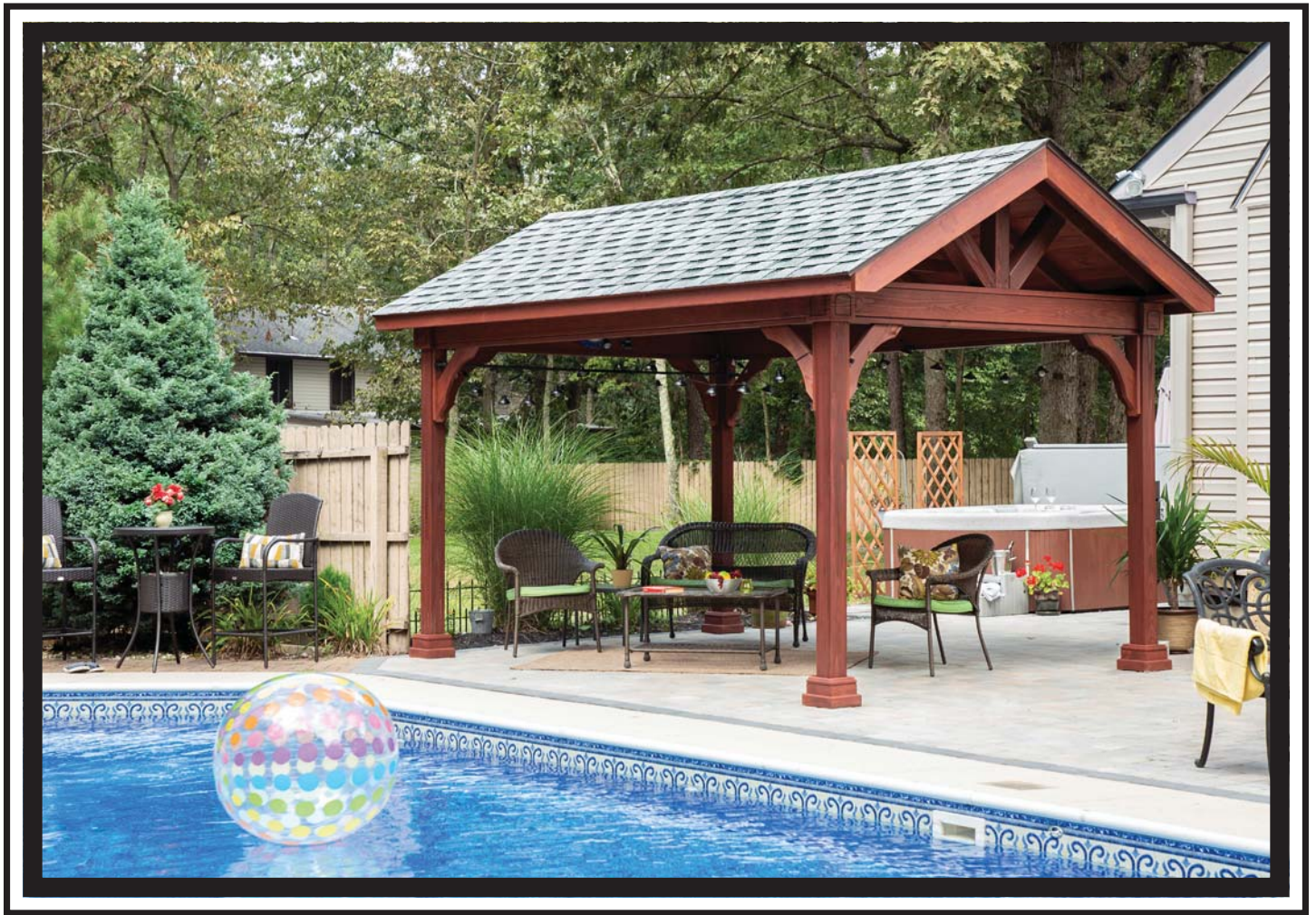

Enjoy your New Pavilion!